

REQUIREMENTS:

1. SIZE AND LOCATION OF INTERCEPTOR TO BE APPROVED PRIOR TO INSTALLATION, MIN. TANK SIZE SHALL BE 750 GAL
2. INTERCEPTOR TO HAVE:
 - a. SAMPLE BOX
 - b. SANITARY TEE; INSIDE SAMPLE BOX, DISCHARGE SIDE
 - c. VENT
 - d. CLEANOUT PRIOR TO LATERAL CONNECTION
 - e. MANHOLE AT EACH INTERNAL BAFFLE TUBE -- NO MORE THAN 10' BETWEEN MANHOLES
3. INSPECTION OF INTERCEPTOR:
 - a. ALL CONNECTIONS TO INTERCEPTOR TO BE INSPECTED BY CITY PRIOR TO BACKFILL
 - b. INTERCEPTOR TO BE FILLED WITH WATER PRIOR TO INSPECTION, PER MANUFACTURERS INSTRUCTION OR REQUEST.
4. ALL MANHOLES AND SAMPLE BOXES TO BE INSTALLED A MINIMUM OF 1/2" ABOVE FINISH.
5. GRADE/PAVEMENT WITH A CONCRETE COLLAR A MINIMUM OF 18" AROUND ALL MANHOLE LIDS AND 12" DEEP. CONCRETE COLLAR, SAMPLE BOX FITTING, AND ALL EXTERIOR PIPING SUPPLIED BY INSTALLER.

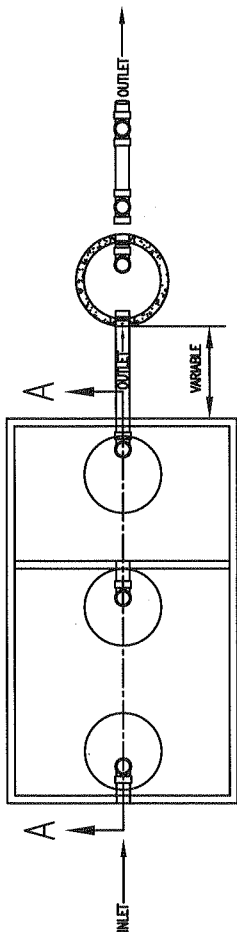

PLAN VIEW

SAMPLE BOX

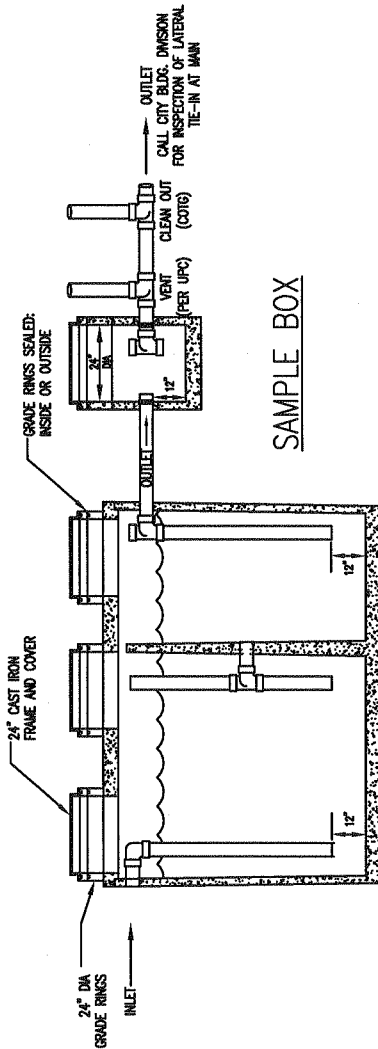

SIDE VIEW

SAMPLE BOX

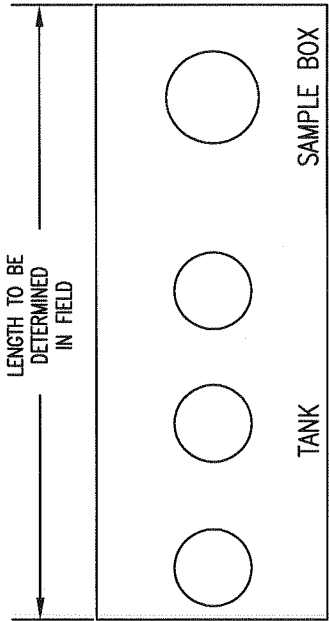

CONCRETE COLLAR DETAIL
PLAN VIEW



SIDE VIEW



END VIEW

GREASE INTERCEPTOR TANK WITH SAMPLE BOX

STANDARD PLAN

299

APPROVED		REVISIONS		SUPERCEDES REFERENCES	
<p>APPROVED</p> <p><i>Bob Jackson</i> 9/26/07</p> <p>BUILDING OFFICIAL / DATE</p>		NO.		STD PLAN 299	
		DESCRIPTIONS		DATED 03-2006	
<p>APPROVED</p> <p><i>[Signature]</i> 9/27/07</p> <p>DIRECTOR OF PUBLIC WORKS - PER 57202 / DATE</p>					
DRAWN BY : NW		CHECKED BY : GV		NOT TO SCALE	